

Soil Map

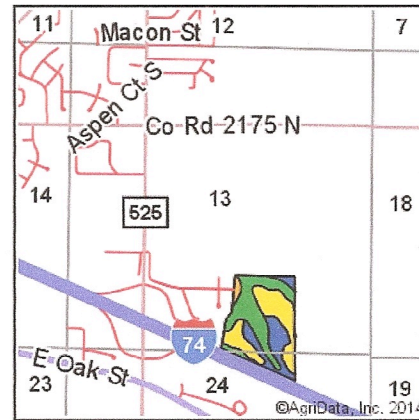

State: **Illinois**
 County: **Champaign**
 Location: **13-20N-7E**
 Township: **Mahomet**
 Acres: **164.44**
 Date: **8/12/2014**

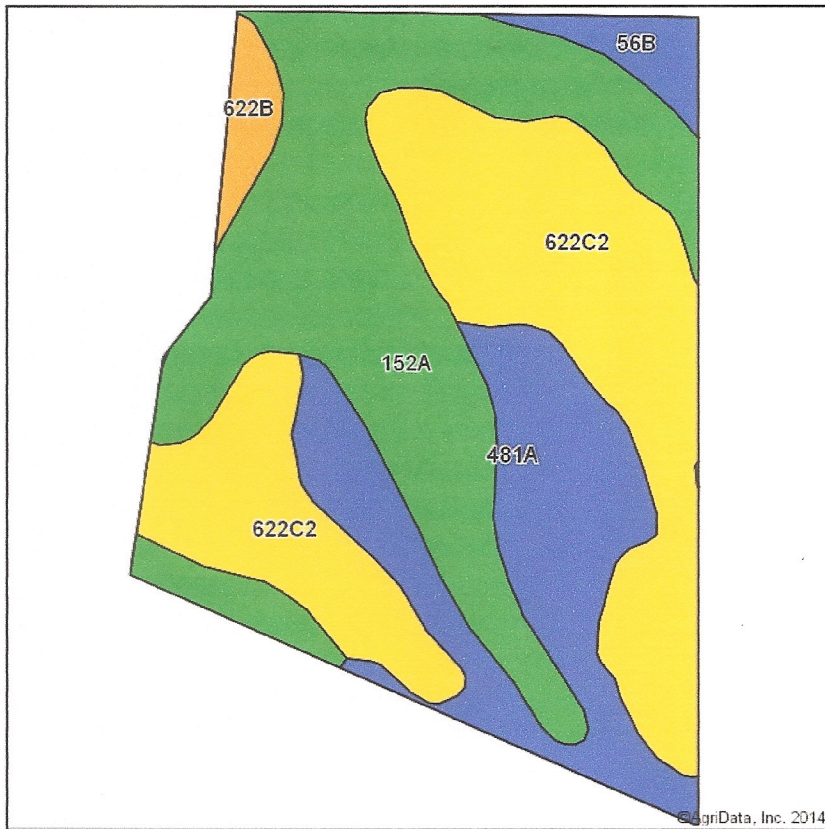
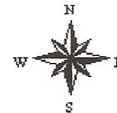

Area Symbol: IL019. Soil Area Version: 8							
Code	Soil Description	Acres	Percent of field	Il. State Productivity Index Legend	Corn Bu/A	Soybeans Bu/A	Crop productivity index for optimum management
152A	Drummer silty clay loam, 0 to 2 percent slopes	61.24	37.2%		195	63	144
**622C2	Wyanet silt loam, 5 to 10 percent slopes, eroded	61.08	37.1%		**150	**49	**112
481A	Raub silt loam, 0 to 2 percent slopes	33.96	20.7%		183	58	134
**56B	Dana silt loam, 2 to 5 percent slopes	4.36	2.7%		**178	**55	**130
**622B	Wyanet silt loam, 2 to 5 percent slopes	3.80	2.3%		**159	**52	**119
Weighted Average					174.5	56.3	129.1

Area Symbol: IL019, Soil Area Version: 8

Table: Optimum Crop Productivity Ratings for Illinois Soil by K.R. Olson and J.M. Lang, Office of Research, ACES, University of Illinois at Champaign-Urbana. Version: 1/2/2012 Amended Table S2 B811 (Updated 1/10/2012)

Crop yields and productivity indices for optimum management (B811) are maintained at the following NRES web site: <http://soilproductivity.nres.illinois.edu/>

** Indexes adjusted for slope and erosion according to Bulletin 811 Table S3

Field borders provided by Farm Service Agency as of 5/21/2008. Aerial photography provided by Aerial Photography Field Office.